

# Harvesters Way - Phase 2

## Stair 2 \_ Apartments

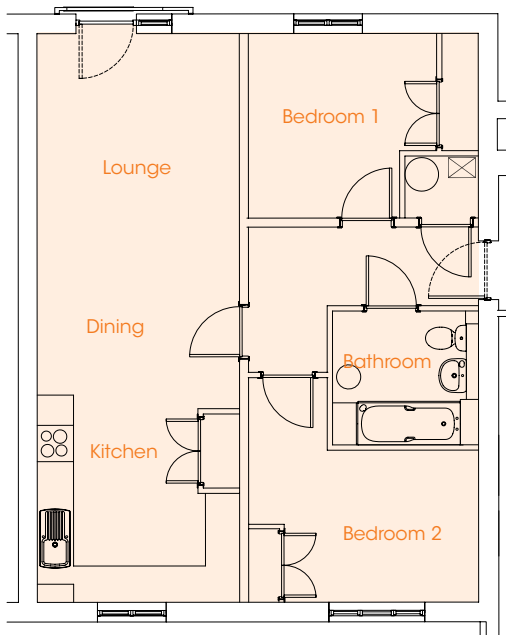
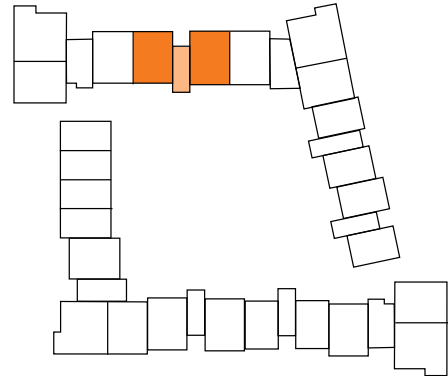

Plot 103  
Third Floor

	Metric	Imperial
Kitchen	3.24 x 3.29	10'8" x 10'10"
Dining	3.24 x 2.41	10'8" x 7'11"
Lounge	3.24 x 3.69	10'8" x 12'1"
Bedroom 1	3.21 x 3.05	10'6" x 10'0"
Bedroom 2	3.90 x 3.71	12'10" x 12'2"
Bathroom	2.41 x 2.21	7'11" x 7'3"

